





## 6/18 Gorman Street Marrickville NSW

2  3  1 

Welcome to a complex of only 8 near new townhouses converted from an original warehouse that dates back to the late 19th Century. Originally a Joinery, it was later used as a Sheet Metal business, then in recent years an Artists Studio.

Introducing a spacious 2 bedroom townhouse with modern comforts and rustic charm.

Featuring,

- Open plan living
- Full brick construction
- North facing
- 2 large bedrooms with built in wardrobes
- En suite to the main bedroom with the luxury of a bath tub
- Modern kitchen with gas cook top, dishwasher and ample of bench space
- Ducted air conditioning
- 2 separate living areas

**Land Size** : 172 sqm

**View** : <https://www.crystalrealty.com.au/sale/nsw/inner-west/marrickville/residential/townhouse/4707804>



**May Aoun**  
0416 027 086

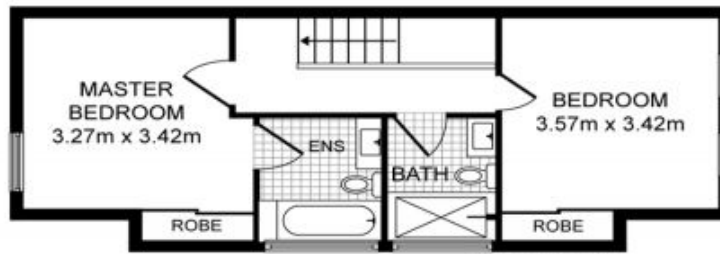

FRIST FLOOR

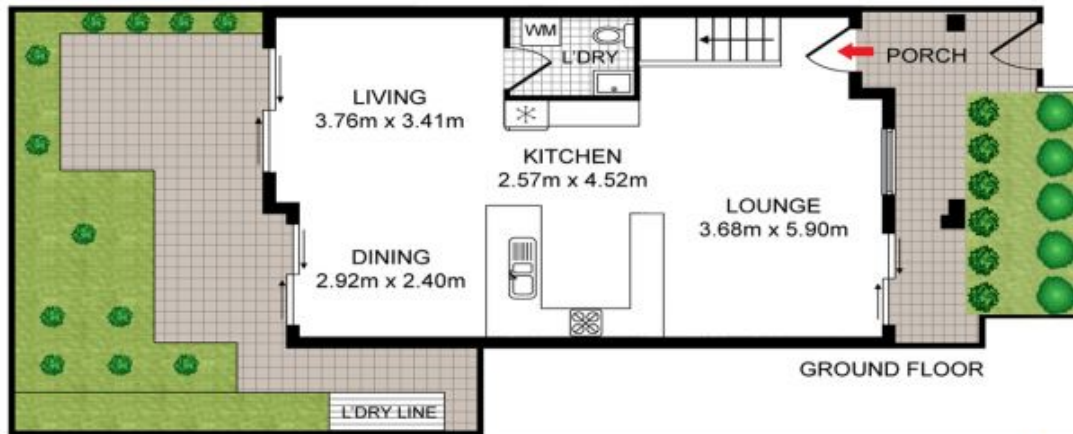

GROUND FLOOR

### 6/16-18 Gorman St, Marrickville

Whilst every attempt has been made to ensure the accuracy of the floor plan contained here, measurements of doors, windows, rooms and any other items are approximate and no responsibility is taken for any error, omission or mis-statement. This plan is for illustration purpose only and should be used as such by any prospective purchaser. The services, systems and appliances shown have not been tested and no guarantee as to their operability or efficiency can be given.

Photos & Floor Plan created by SMT CLICKS

