



105/144 Mallett Street Camperdown NSW

1  1 

An opportunity for a modern self-contained studio apartment offering an ultra-city lifestyle, set in a tranquil sought after pocket in Camperdown.

With major landmarks all within a short walk. Camperdown Commons down the road offers basketball courts, tennis courts, dog park and a community garden café. RPA, USYD and surrounding cafes and restaurants in Newtown are all nearby.

Features to love about the unit include:

- Secure access, intercom, elevator and communal swimming pool.
- Basement parking for secure off street parking
- Split system air conditioner for Sydney summer!
- Modern Caesar stone kitchen fitted with modern appliances, microwave, fridge/freezer and washing

Price : \$ 460,000
Land Size : 32 sqm
View : <https://www.crystalrealty.com.au/sale/nsw/inner-west/camperdown/residential/unit/5089546>



May Aoun
0416 027 086

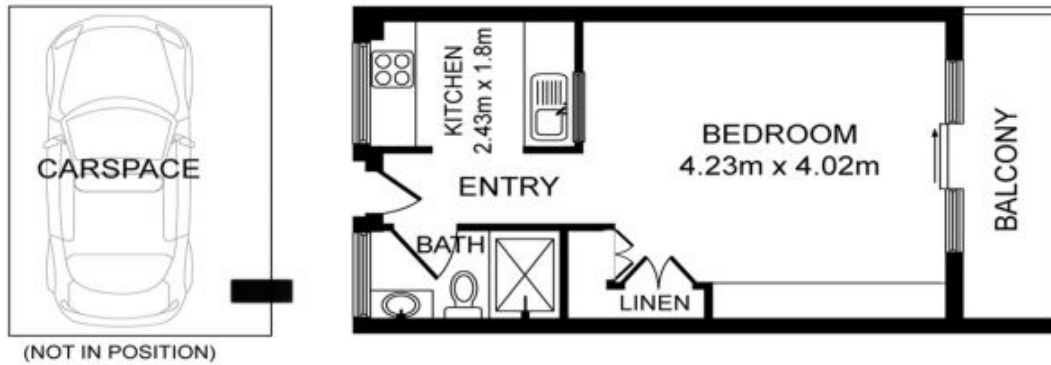

105/144 Mallett Street, Camperdown

Whilst every attempt has been made to ensure the accuracy of the floor plan contained here, measurements of doors, windows, rooms and any other items are approximate and no responsibility is taken for any error, omission or mis-statement. This plan is for illustration purpose only and should be used as such by any prospective purchaser. The services, systems and appliances shown have not been tested and no guarantee as to their operability or efficiency can be given.

Photos & Floor Plan created by SMT CLICKS

