

63 Park Street ERSKINEVILLE NSW

2  1 

Neat and tidy, two bedroom, single terrace in a beautiful wide tree lined street. The property consists of two good size bedrooms, neat kitchen and bathroom, internal laundry and courtyard. Very quiet and quaint area.

Land Size : 115 sqm
View : <https://www.crystalrealty.com.au/sale/nsw/inner-west/erskineville/residential/terrace/5771802>

Across from the park and close to the village, this is one not to be missed.

Total rental income: \$420.00per week, Total Area Approx: 115sqm, Water Rates: \$255.85 per 1/4, Council Rates: \$246.50 per 1/4



Angela Lytsioulis
0295194644

COURTYARD

4.4 x 6.0

BATH/LDY

3.4 x 1.4

KITCHEN

3.4 x 2.0

LIVING

3.4 x 3.0

BED

3.4 x 3.4

BED

3.4 x 3.4

BALCONY

4.4 x 1.0



63 Park Street, Erskinville

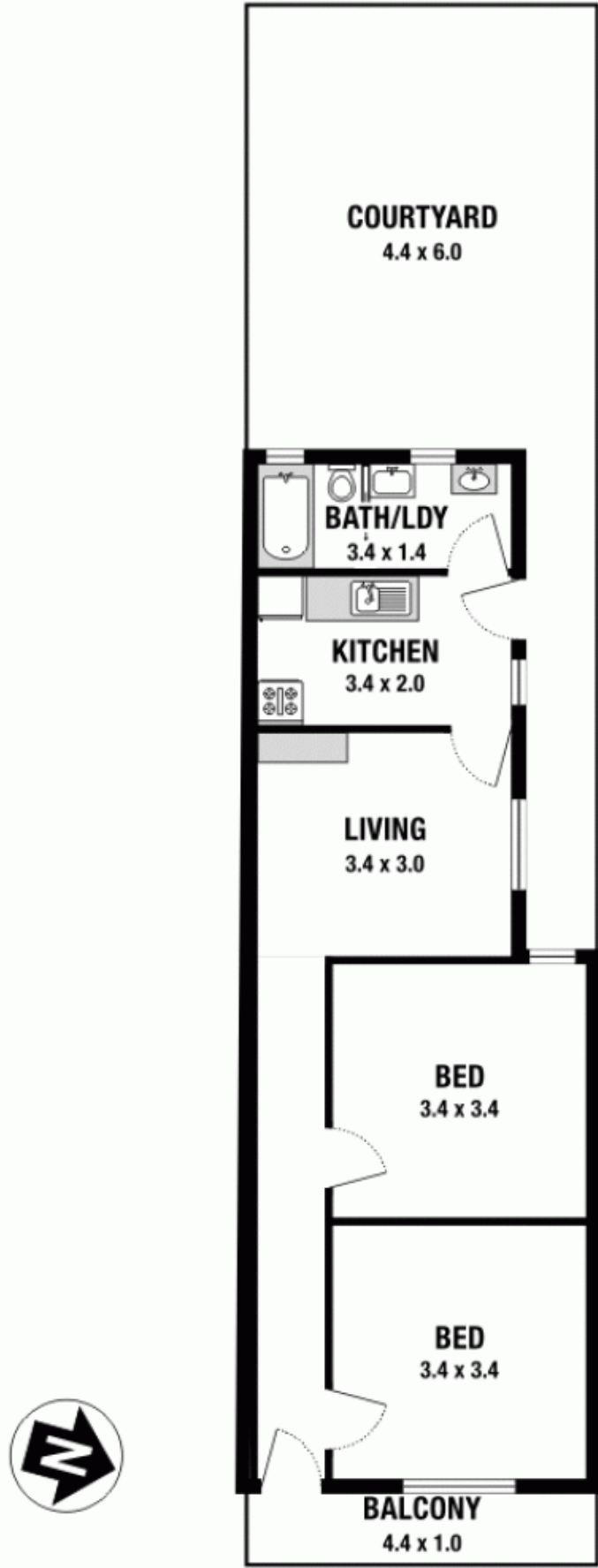

Please note: All stated dimensions are approximate only. Particulars given are for general information only and do not constitute any representation on the part of the vendor or agent.