



**242 Belmont Street ALEXANDRIA NSW**

3  2  1 

Here lies an opportunity not to be missed. This two storey terrace is located in a sought after area of Alexandria and footsteps from Erskineville Village Shops.

Accommodation consists of three double bedrooms, main with a large private balcony, built-ins in two rooms, seperate lounge area, large open plan kitchen with a combined dining room, carpeted throughout, internal laundry, paved courtyard for entertaining with room for parking your car and rear lane access for your convenience.

Located close to Erskineville Village Shops, cafes, schools, public transport and CBD district. A must to inspect for the growing family, active nesters and professionals alike!

**Land Size** : 153 sqm  
**View** : <https://www.crystalrealty.com.au/sale/nsw/eastern-suburbs/alexandria/residential/terrace/5771823>

# 242 Belmont Street, Alexandria

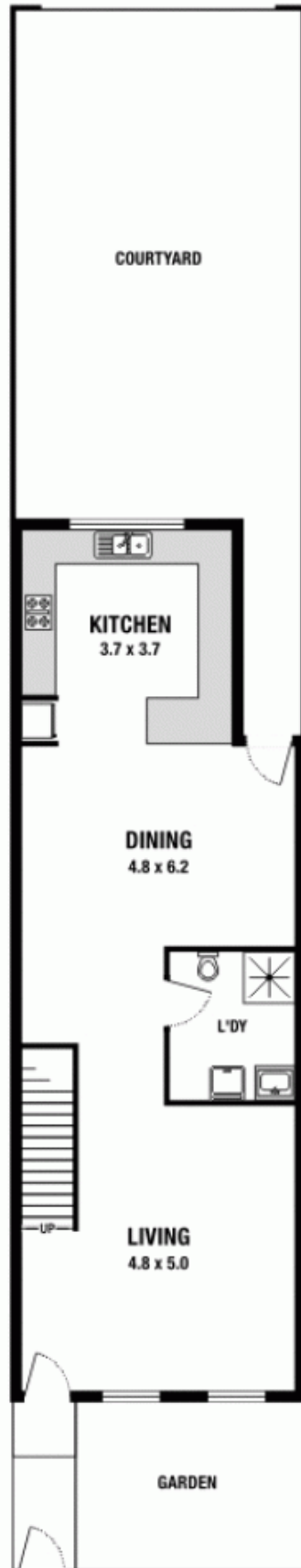

**GROUND FLOOR**



**FIRST FLOOR**

Please note: All stated dimensions are approximate only. Particulars given are for general information only and do not constitute any representation on the part of the vendor or agent.