



6/54 Regent Street Chippendale NSW

2  1  1 

Tucked away to the rear of a landmark security building, this modern two-bedroom apartment delivers an outstanding opportunity for owner-occupiers and investors in the heart of Chippendale.

A streamlined layout, clean contemporary lines and modern finishes define open plan living/dining areas plus there is a sleek stone kitchen with an electric cooktop and abundant cupboard storage.

Accommodation comprises two well-sized bedrooms, main appointed with built-in wardrobe plus there is a stylish fully tiled bathroom. Additional features include a concealed internal laundry, split-cycle air conditioning and lift access to a secure basement car space.

Residents enjoy access to a communal sun bathed

Price : \$799,000

View : <https://www.crystalrealty.com.au/sale/nsw/sydney-city/chippendale/residential/unit/7969511>



May Aoun
0416 027 086

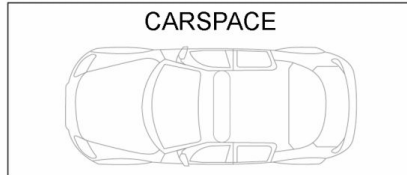
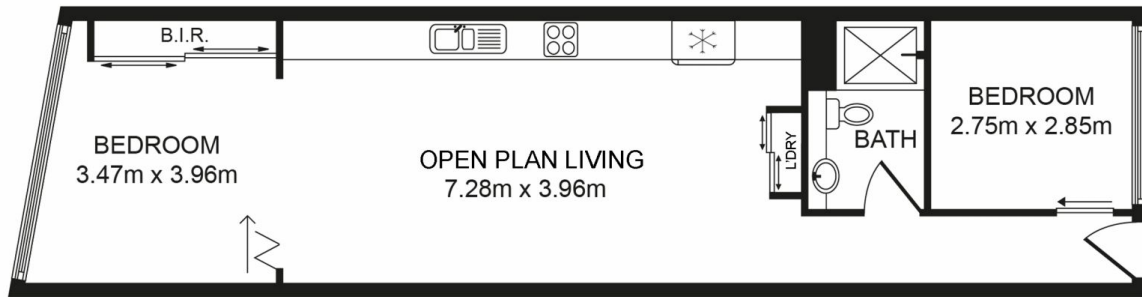

(NOT IN POSITION)

6/54 Regent St, Chippendale NSW 2008

Whilst every attempt has been made to ensure the accuracy of the floor plan contained here, measurements of doors, windows, room and any other items are approximate and no responsibility is taken for any error, omission or mis-statement. This plan is for illustration purpose only and should be used as such by any prospective purchaser. The service, systems and appliances shown have not been tested and no guarantee as to their operability or efficiency can be given.

Photos & Floor Plan created by SMT Clicks | 0478 099 674

